

PRODUCT No. 43812

SUPER-MULTI-COATED

TAKUMAR 1:2.5 135mm



EXPLODED ILLUSTRATION

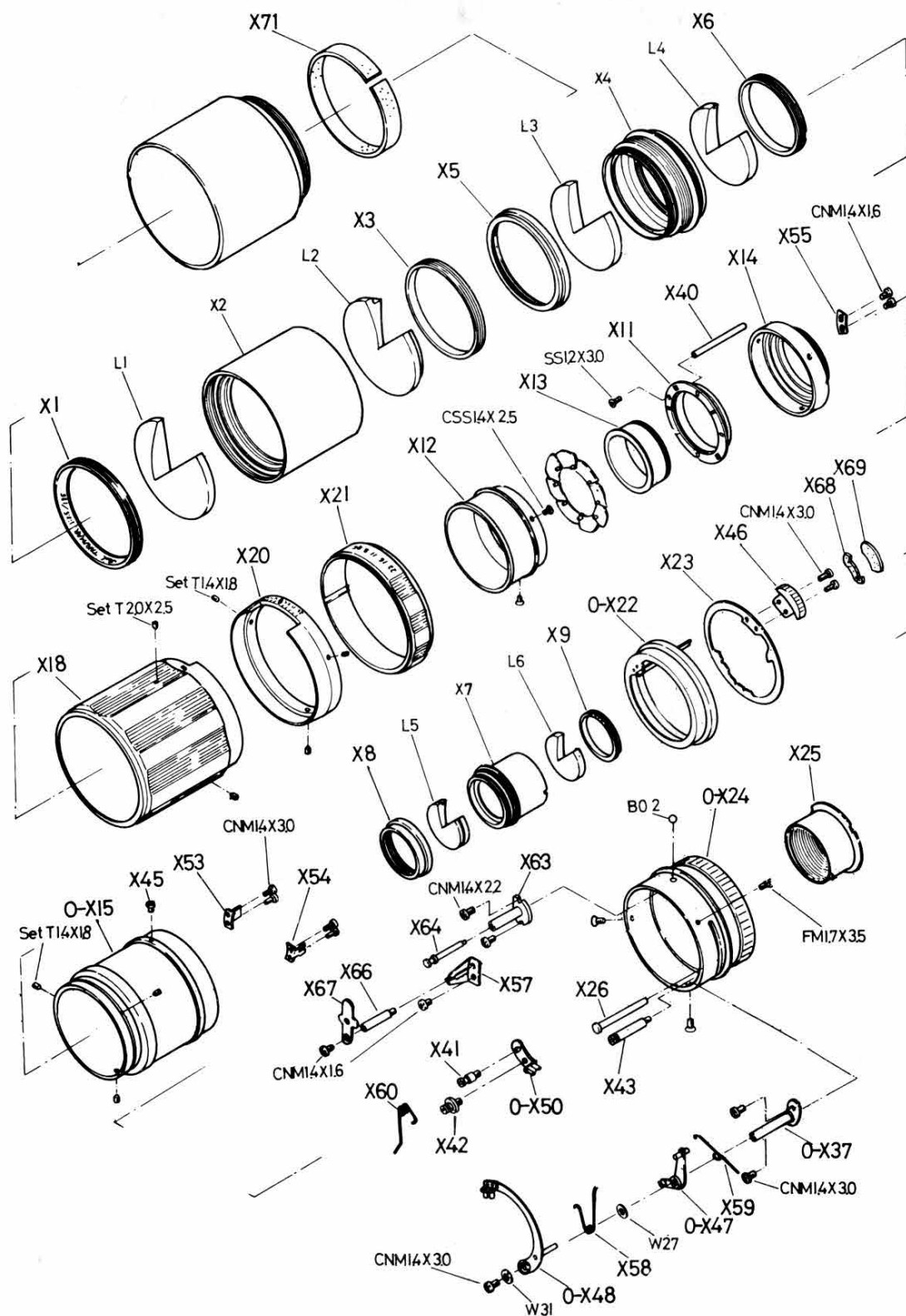

Product No, 43812

Super-Multi-Coated TAKUMAR 1 : 2.5 135mm
2

LIST OF SERVICE PARTS

Product No. 43812

SUPER-MULTI-COATED TAKUMAR 1:2.5 135mm

Note: 1. The parts with numbers starting '0-' are assembled parts.

2. Only the available parts are listed below.

Parts No.	Description	Quantity	Interchangeability
X1	Nameplate ring	1	
X3	2nd lens retainer ring	1	
X5	3rd lens retainer ring	1	
X6	4th lens retainer ring	1	
X8	5th lens retainer ring	1	
X9	6th lens retainer ring	1	
0-X10	Diaphragm blade assembly(X10, X27x2)	8	
X11	Opening and closing ring	1	
X12	Supporter ring	1	
X13	Opening and closing ring retainer	1	
X14	Install ring	1	
0-X15	Main barrel assembly (X15, X16, X17, X19, X53, X54, CNM1.4x3.0x4)	1	
X18	Distance scale ring	1	
X20	Depth of field scale ring	1	
X21	Diaphragm scale ring	1	
0-X22	Diaphragm turning ring assembly (X22, X61, X65x2)	1	
X23	Manual plate	1	
0-X24	Seat ring assembly(X24, X36, X56, X62)	1	
X25	Light seal ring	1	

Parts No.	Description	Quantity	Interchangeability
X26	Release pin	1	43832-X26
0-X37	Cam lever shaft assembly(X37, X52)	1	
X40	Diaphragm turning pin	1	
X41	Intermediate lever install plate retainer screw	1	43832-X41
X42	Release spring hanger screw	1	43832-X42
X43	Opening spring hanger screw	1	43982-X44
X44	Diaphragm turning screw	2	43832-X44
X45	Distance restriction screw	1	43832-X45
X46	Manual lever	1	
0-X47	Actuator lever assembly (X47, X31, X32, X33, X39)	1	
0-X48	Cam lever assembly (X48, X31, X35, X38, X49)	1	
0-X50	Intermediate lever assembly (X50, X29, X30, X31, X51)	1	
X53	Helicoid guide plate	1	
X54	Helicoid guide plate	1	
X55	Aperture adjusting plate	1	
X57	Manual click spring	1	
X58	Diaphragm spring	1	
X59	Diaphragm opening spring	1	
X60	Release spring	1	
X63	Hook pin bearing	1	43742-X66-01
X64	Hook pin	1	43982-X66

Parts No.	Description	Quantity	Interchangeability
X66	Hook pin spring install screw	1	43982-X68
X67	Hook pin spring	1	43542-X72
X68	Manual lever light seal	1	43982-X62
X69	Manual lever light seal	1	43982-X69
X71	Cloth	1	43762-X63

LIST OF STANDARD PARTS

Product No. 43812

SUPER-MULTI-COATED TAKUMAR 1:2.5 135mm

Small screws:

Description	Surface treatment	Position of use	Quantity
SS1.2X3.0	Black nickel	X40	1
CNM1.4X1.6		X14, X55	2
		X24, X56	1
		X67, X66	1
CNM1.4X2.2	"	X24, X63	2
CNM1.4X3.0	"	X15, X53	2
		X15, X54	2
		X24, X52	2
		X23, X46	2
		X37	1
CSS1.4X3.0	"	X12, X14	3
CSS1.7X3.5	"	X17, X24	3
Set T 1.4X1.8	"	X12, X15	3
		X20, X24	3
Set T 2.0X2.5	"	X18, X19	3

Washers:

Description	Material	Thickness	Position of use	Quantity
W27	Brass	0.1, 0.05mm	X37	1
W31	"		X37	1

Ball:

Description	Material	Diameter	Position of use	Quantity
BO2	Steel	2.0mm	X21, X24	1