

1. Three-Point-Adjustment

- Sequence of arrest:
- a. M-detent 664.
 - b. Opening pin.
 - c. Locking lever on bridge.

The adjustment must be made so points 1 and 3 coincide with position 2.

SECTION 3 - DISASSEMBLY

3-1. GENERAL

This section contains disassembly procedures for the 1110 Shutter for the Rollei camera. Figures 3-1 through 3-9 help in determining disassembly sequence and malfunction.

CAUTION

Disassemble the 1110 Shutter
in a released condition only.

3-2. SEQUENCE OF DISASSEMBLY

Completely disassemble the 1110 Shutter before attempting any repair, cleaning or lubrication. The 1110 Shutter should be disassembled in the following proper sequence:

1. Lock screw 538 for retaining ring 547.
2. Retaining ring 547.
3. Cover plate with exposure setting ring, slotted cam ring and release lock, if provided.
4. Cocking pinion 517.
5. Cocking ring with spring 528/521.
6. Release lever 508
7. Main drive spring 515.
8. Drive cam 514.
9. Escapement 300 and self-timer mechanism 400.
10. Bulb speed lever with spring 669/151.
11. Two bridge screws 418/620.
12. Spring and bridge 672/621.

13. X-contact lever 615.
14. M-contact lever 612.
15. Spring (M-detent) 641.
16. Gear segment 635.
17. M-spur gear 632.
18. Gear segment lever spring 619.

Turn Shutter Over

19. Three diaphragm ring guide screws for diaphragm ring 120/108.
20. Diaphragm setting ring 150.
21. MXV setting ring 148.
22. Three casing screws 109.
23. Casing 101.
24. Remove shutter blades according to sequence.
25. Put base plate on assembly jig and remove two screws 201 from lens mount tube 204.
26. Lens mount tube 204.
27. Remove tension from sector ring closing spring 249.
28. Sector ring 202.

Disassembling Casing

29. Three screws 117.
30. Sector cover 116.
31. Turn casing over so that diaphragm segments and diaphragm cover fall out.

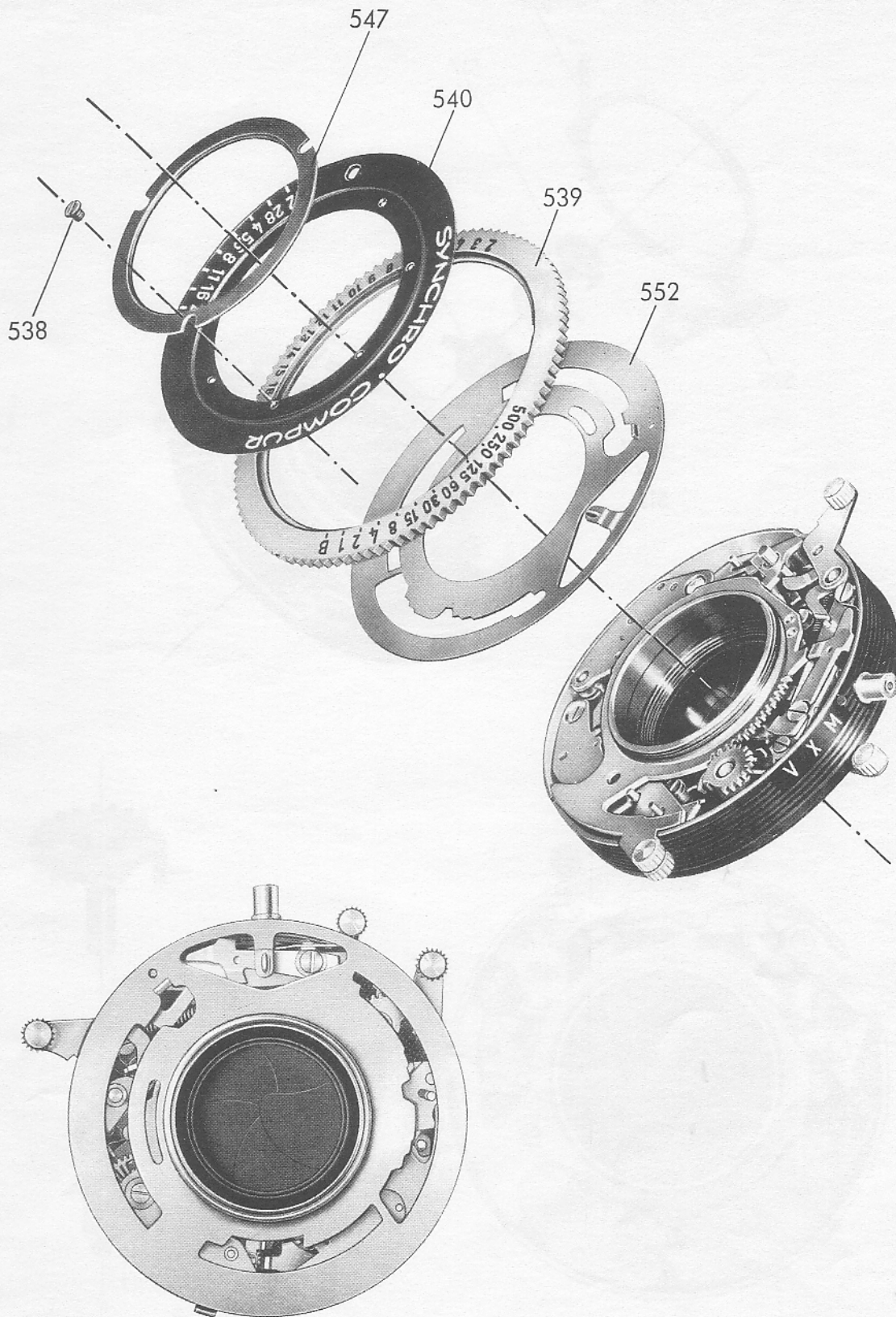

Figure 3-1

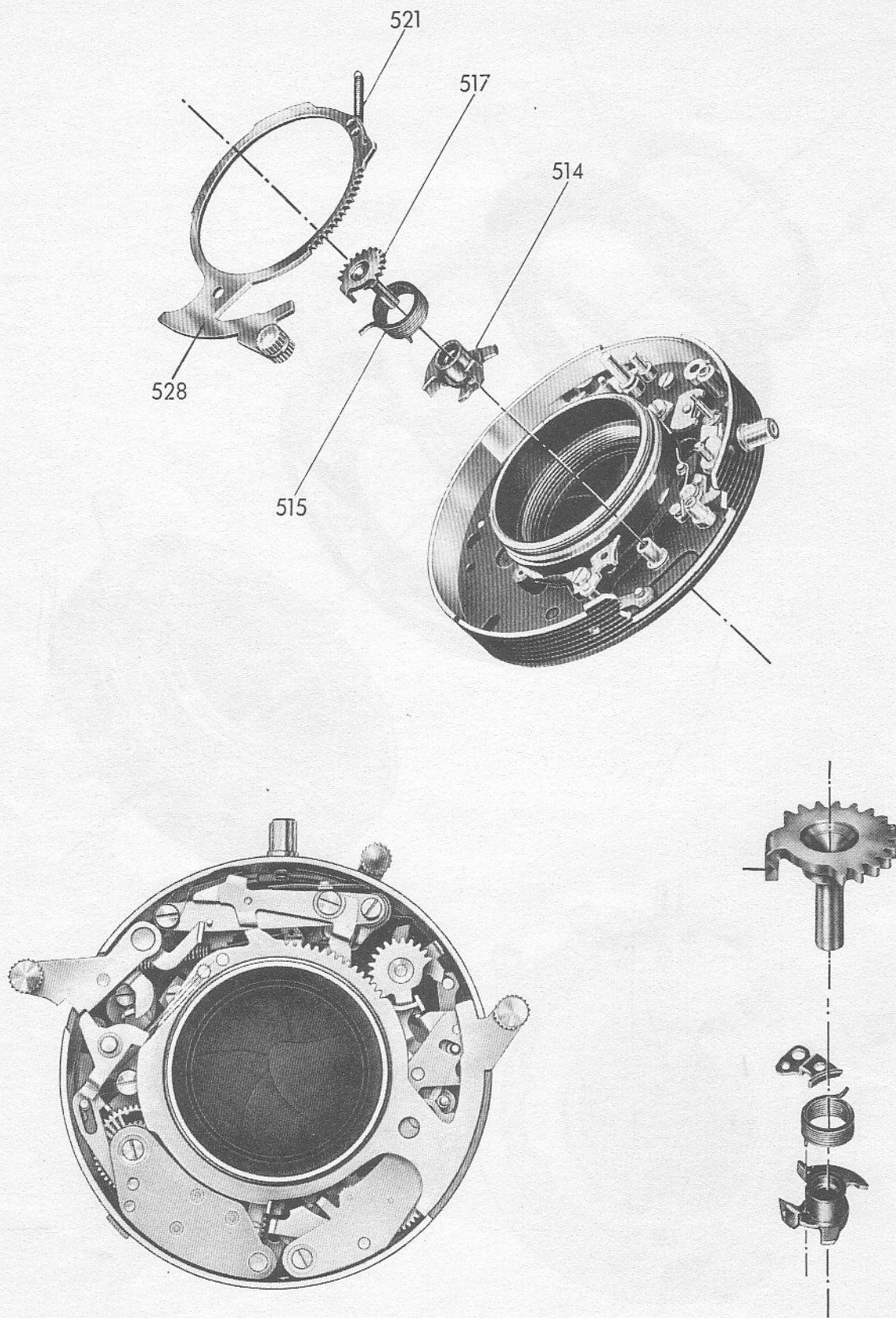
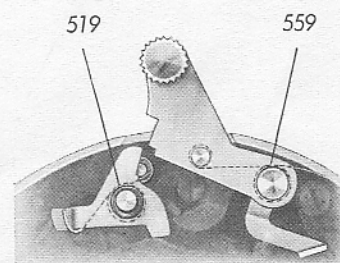
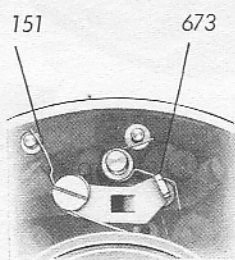
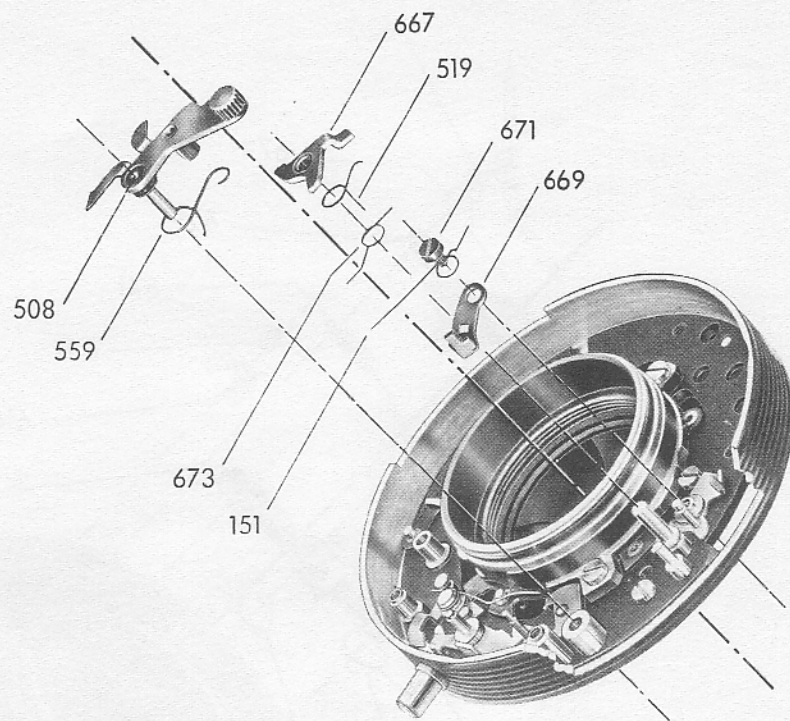

Figure 3-2



1210-000

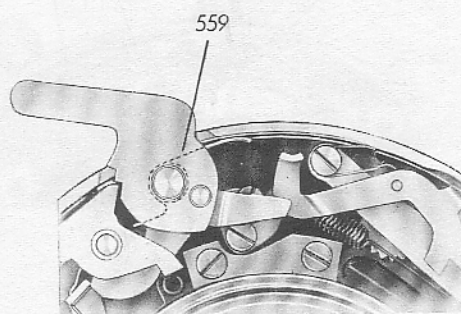
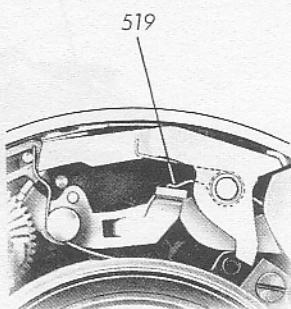

Figure 3-3

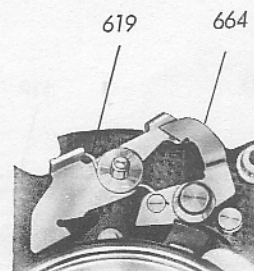
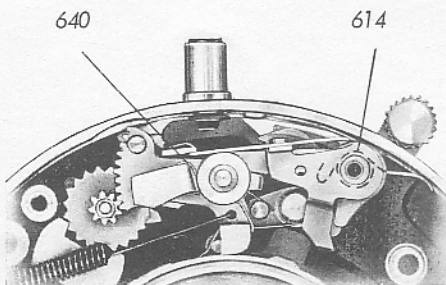
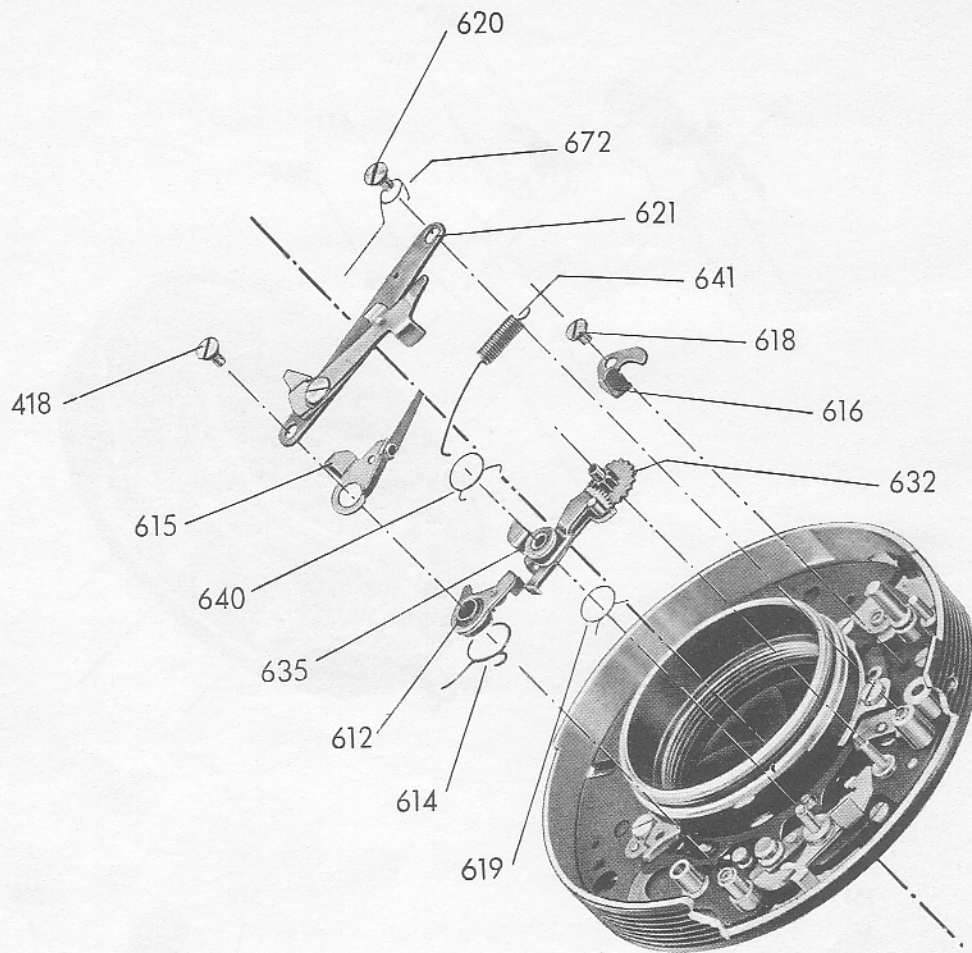

Figure 3-4

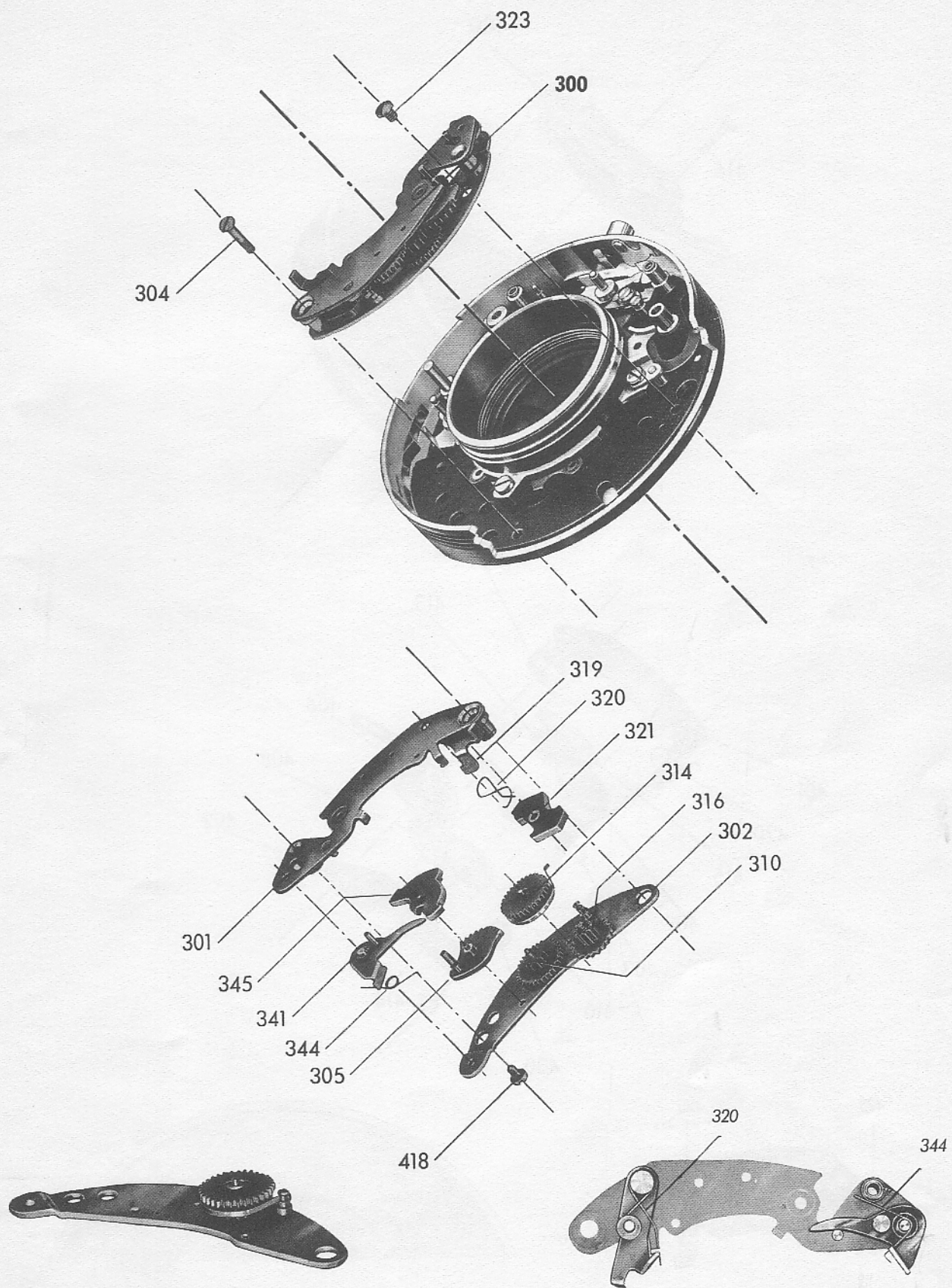

Figure 3-5

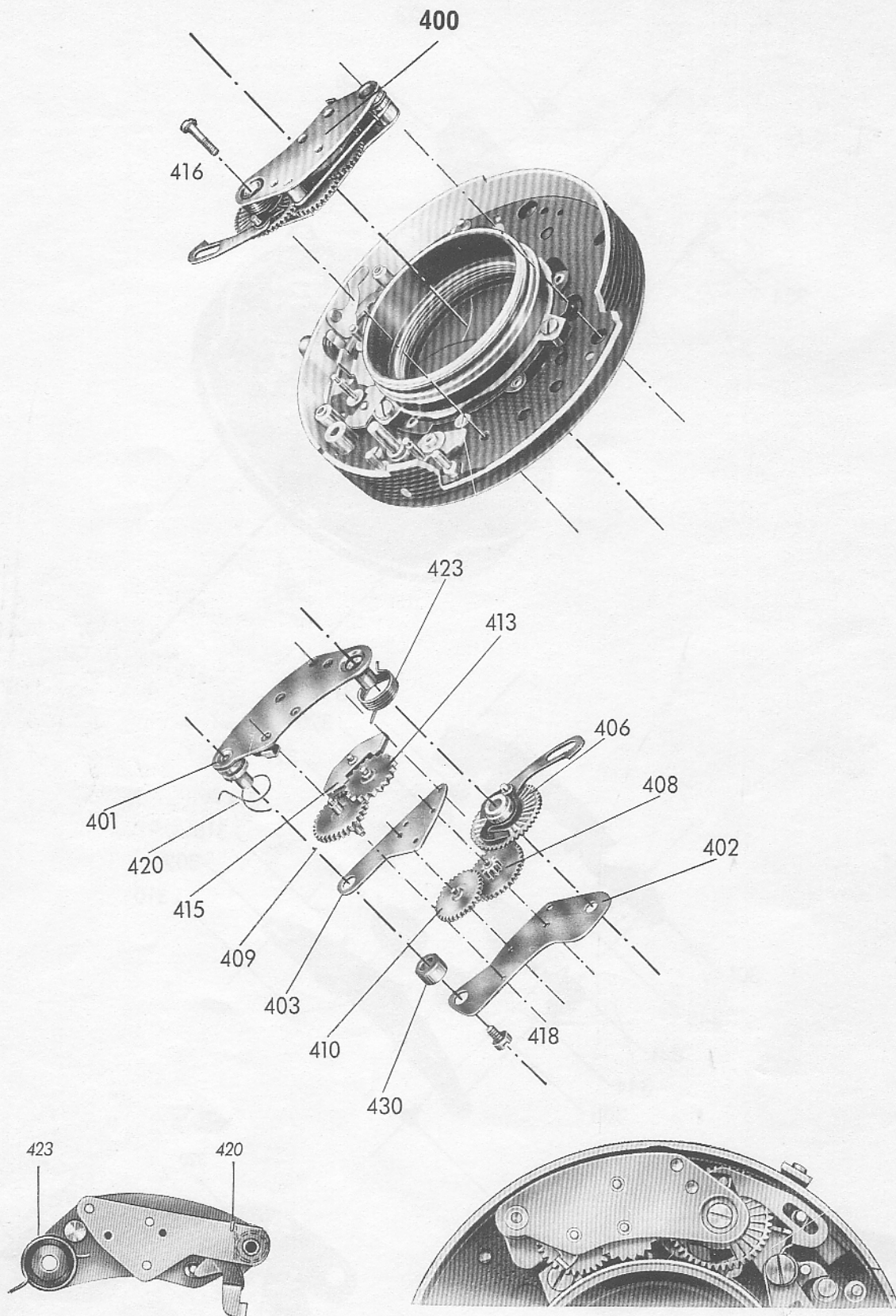

Figure 3-6

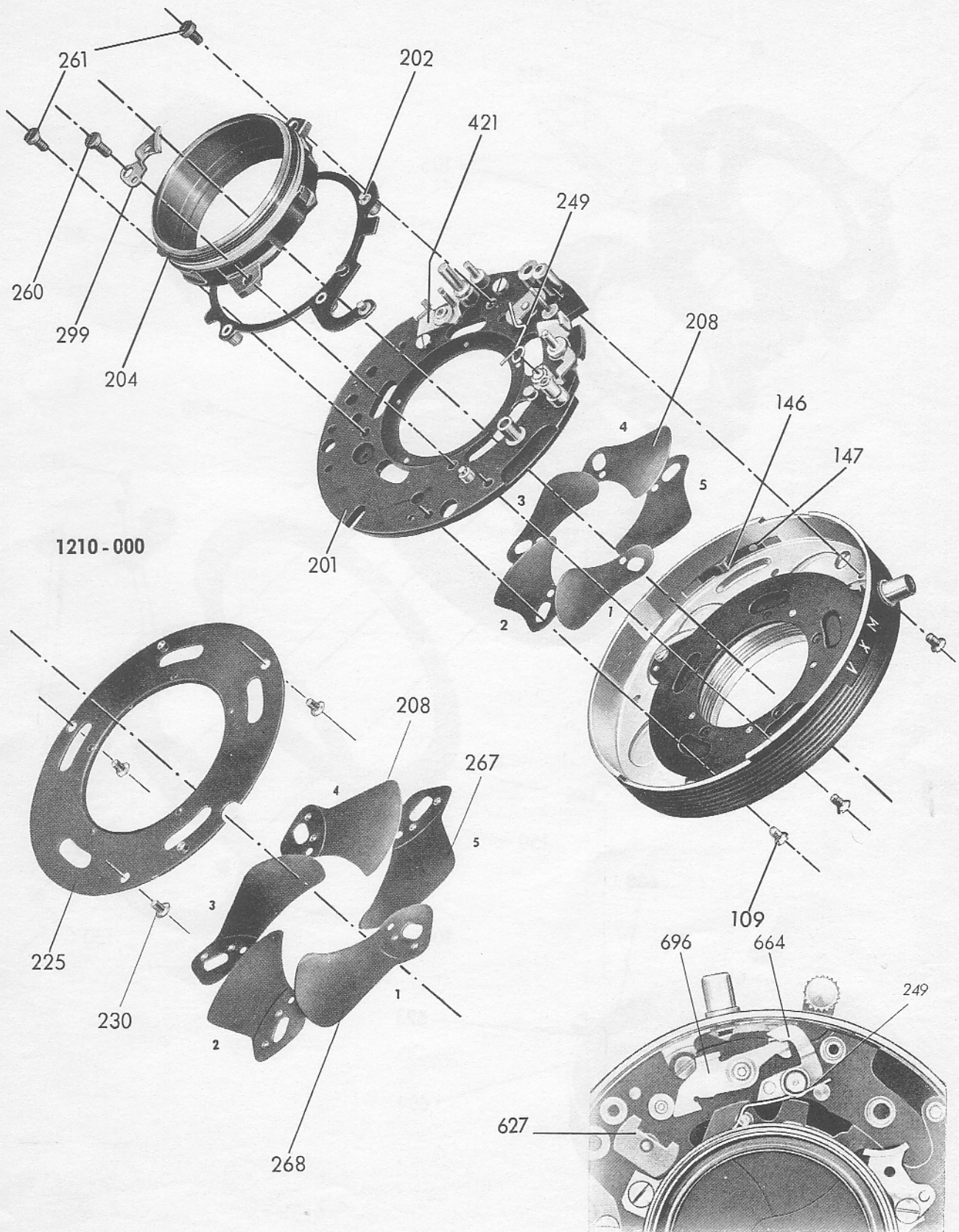

Figure 3-7